



Kea Cabin

Important Notes.

To give some background- we import the bulk of your cabin from Europe. To make our customers experience building their cabin as quick and easy as possible we include in the kitset, Nura Jack Piles, Timber bearers, Timber roof purlins and NZ made Iron Roofing. Below are instructions to build the subfloor, helpful tips to go with the manufacturer's instructions for the rest of the cabin. And instructions for fitting the iron roof.

It's recommended you leave the white wrapped pallet wrapped up until you have the piles and bearers in place. As when the packet is wrapped its holding the cabin wall timber nice and straight, makes clipping the walls together easier.

You will find further instructions from the manufacturer inside the white wrapped pallet.

Cabin needs to be painted or stained with a quality product soon after being erected.

There are a few spares provided so don't be alarmed that you have plenty of leftovers. Also provided are extra square drive screws as this is a lot quicker than the screws provided in the white pallet. You will have plenty of screws left over

Note, pictures may not be of a Kea Cabin but they show the process.

Marking out piles (Nura Jacks)

Mark out on the ground outline of cabin (6200mm x 4680mm) get this square (measuring on a diagonal)

Mark out for 28 piles over 7 runs of bearers, 4 piles per bearer(1556mm apart)

Find the highest point. Scrape away grass or loose soil. If being built over hard ground, sit Nura Jack directly on ground. If your site is not very level you will need to purchase 200x150 pavers (or similar) from a hardware store to place under the Nura Jacks. Wind the first Nura Jack fully down. This is your starting point. Now wind every nura jack up level to the height of your first pile. Use additional pavers if you run out of thread on the Nura Jack.

If you want to install the moisture barrier (black polythene) lay this under the Nura Jacks.

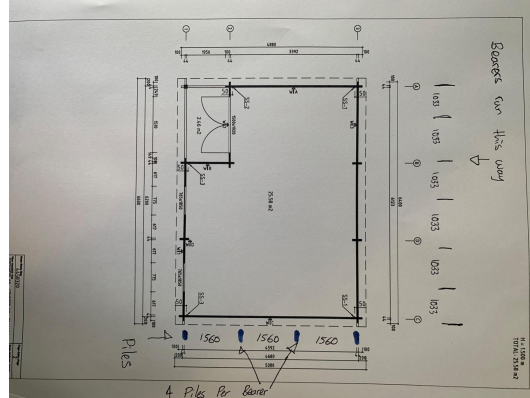

Bearers & Joists

Place the bearers on top of Nura Jacks, you can leave them longer for now and cut them off at the end.

Bearers need to be perfectly level, but they do not need to be perfectly square, straight or evenly spaced out.

Screw bearers to the piles. (50mm screws or similar)

Now unpack white wrapped pallet, place joists on top of bearers and follow manufacturers instructions.

Screw all the joists together before screwing any joists to bearers. Using a tape measure on the diagonal angle, get the joists square. Screw every joist to every bearer (100mm screw or similar)

Follow manufacturer's instructions for spacing joists out.

If you wish to insulate the underfloor do this now.





Wall base and floor boards

Follow instructions located inside the pallet to position the first layer of wall timber.

Fit floorboards within these walls

Wall assembly

Using a rubber hammer and a block of wall timber tap each length into place being sure to use the correctly labeled piece of timber. Refer to plans.



Roof rafters

Once the walls are complete, fit the roof rafters as per plans.

Facia board

Since this kit-set comes with an iron roof, disregard how the plans say to fit fascia boards.

Start with the front fascia board, then the two sides.

At this stage you will have some spare long lengths of timber left over, use these for fascia boards



Roof & Flashings

Firstly install the base drip flashing (300mm wide flat, with 100mm drop down)

Now install the long run iron on top of this flashing.

The iron is to sit flush or just a couple of mm back from the front fascia board. The gullies in the roofing iron need to be folded up with an adjustable crescent. This is important as otherwise water can blow up under the flashing. Do this before you sit the sheet in place.

Fit flashings on either side, then at the top, and screw off the complete roof.



Fit windows & doors

Fit windows and doors as per plans.

Fit facings to the exterior of the window first, then place in wall opening before fitting inside facings.

Fit window and door hardware.

